

Type:  
Part no.:

M 10 000-5  
75201500026



Item	Part no.	Designation	Quantity	Price RPR	AT	Country
0010	31322490003	MOTOR HOUSING	1	on req.	-	-
0011	31322518000	PROTECTION CAP	1	on req.	-	-
0020	31322491002	CLAMPING SLEEVE	1	on req.	-	-
0030	31322492005	LEVER	1	on req.	-	-
0040	31322493009	EXHAUST AIR ADAPTER	1	on req.	-	-
0050	31322494007	VALVE SEAT	1	on req.	-	-
0060	31322495001	FLOW CONTROL VALVE	1	on req.	-	-
0070	31322496004	Spring	1	on req.	-	-
0080	31322497008	Packing ring	1	on req.	-	-
0090	31322498006	AIR INLET ADAPTER	1	on req.	-	-
0100	31322499000	VALVE PLUNGER	1	on req.	-	-
0110	31322500008	REGULATOR	1	on req.	-	-
0120	31322501007	Packing ring	1	on req.	-	-
0130	31322502000	RETAINING RING	1	on req.	-	-
0140	31322593005	CLAMPING SLEEVE	1	on req.	-	-
0150	31322504002	LOCKING RING	1	on req.	-	-
0160	31322505006	BALL BEARING	2	on req.	-	-
0170	31322506009	Plate	2	on req.	-	-
0180	31322507003	CYLINDER	1	on req.	-	-
0190	31322508001	BLADE	5	on req.	-	-
0200	31322509005	ROTOR	1	on req.	-	-
0210	31322510007	DISTANCE RING	4	on req.	-	-
0220	31322511006	FITTING KEY	1	on req.	-	-
0230	31322512009	ROTOR SHAFT	1	on req.	-	-
0240	31322513003	DRIVING SHAFT ASS.	1	on req.	-	-
0250	31322514001	LOCKING RING	1	on req.	-	-
0260	31810231005	SUCTION HOOD	1	on req.	-	-
0270	31322515005	Packing ring	1	on req.	-	-
0280	31322516008	Fastening ring	1	on req.	-	-
0290	30234034000	HOSE CLAMP	1	on req.	-	-
0300	30606036003	RUBBER COLLAR	1	on req.	-	-
0310	63806088027	BACKING PAD	1	on req.	-	-
0315	31426028009	ADHERENT PART	1	on req.	-	-
0320	31322517002	CLAMPING SLEEVE	1	on req.	-	-
5000	31322519004	OPEN-JAW SPANNER	1	on req.	-	-
5010	31322520006	AIR HOSE	1	on req.	-	-
9000	34100925066	Operat.instruction	1	on req.	-	-
9010	34150925000	Partslist M10000-5/-6	1	on req.	-	-

Type:  
Part no.:

M 10 000-5  
75201500026

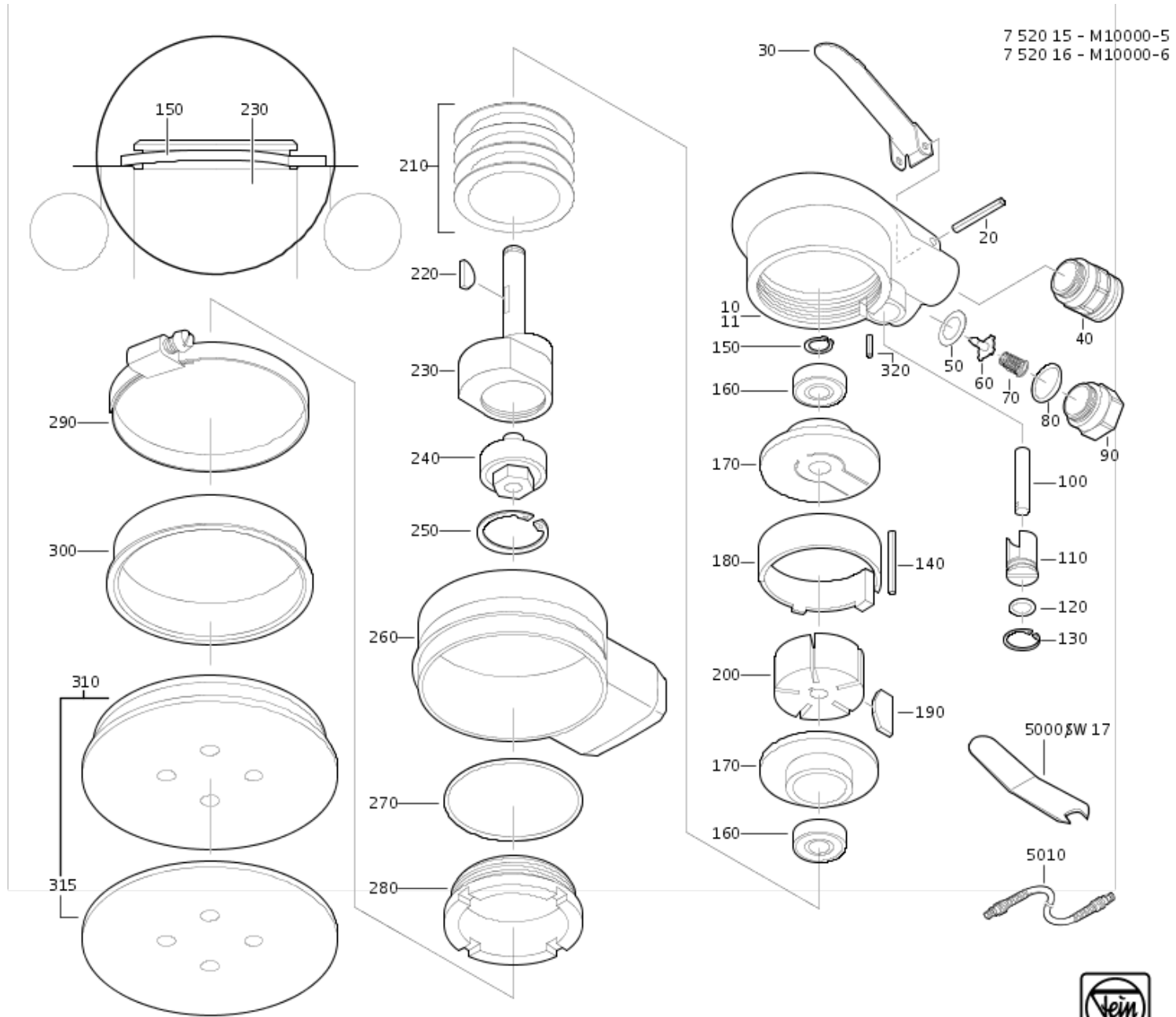

7 520 15 - M10000-5  
7 520 16 - M10000-6

