



SERVICE PARTS LIST

BUL. 54-40-3000

JIG SAW

REVISED BUL 6281-1 DATE Feb. '68

Catalog No. **6250**

Starting Serial No. **281-1001**

WIRING INSTR.

Both Model and Serial No. must be furnished to obtain correct parts.

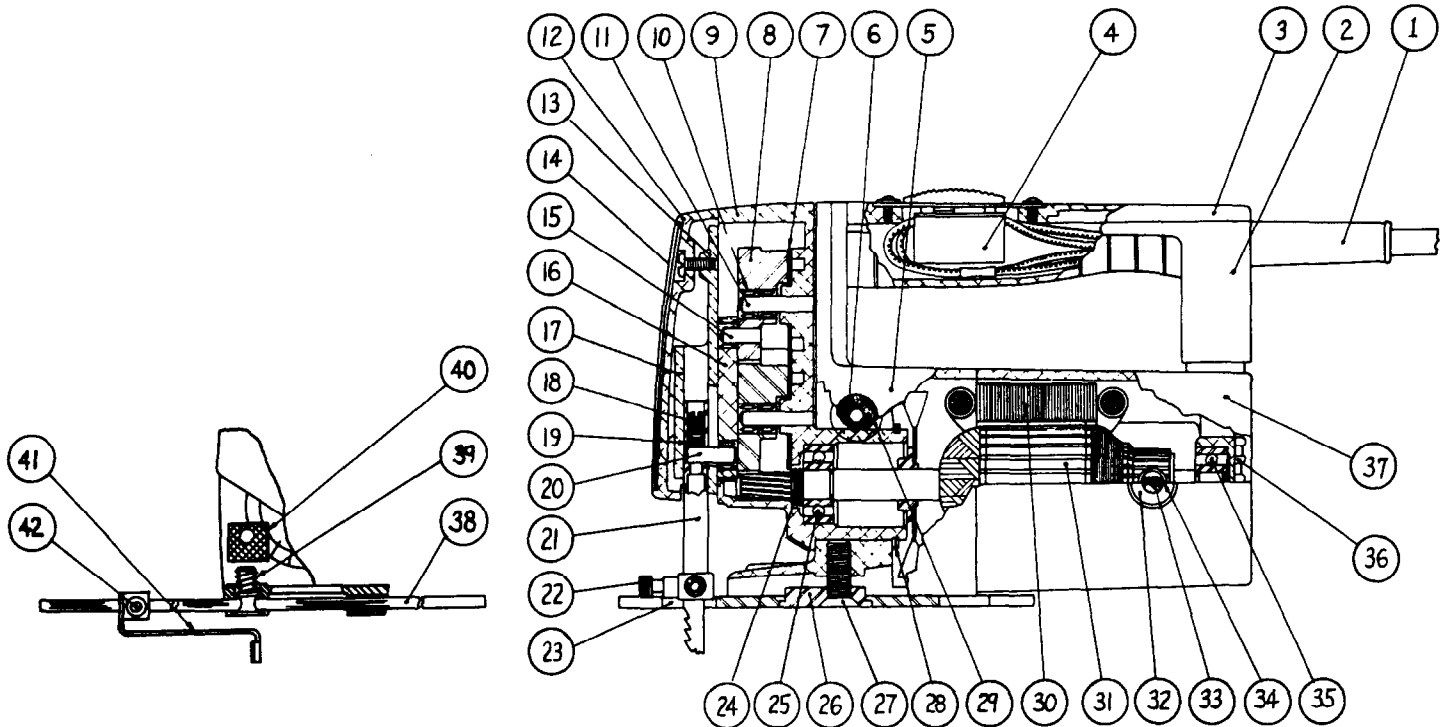

6250 JIG SAW

230V Motor
16-26-1160 Armature
18-26-1060 Field

ILLUSTRATED PARTS

FIG.	PART NO.	DESCRIPTION OF PART	FIG.	PART NO.	DESCRIPTION OF PART	
1	22-64-0220	Cord Set	22	06-75-1985	Blade Retaining Screws	(3)
2	28-44-9261	Handle	23	45-16-0231	Shoe	
3	28-20-3521	Handle Cover	24	45-28-0090	Grease Slinger	
4	23-66-0310	Switch	25	02-04-0940	Ball Bearing (Pinion End)	
5	14-13-0100	Diaphragm	26	45-88-0370	Shoe Adjusting Washer	
6	06-81-3125	Gear Case Clamping Screw	27	06-81-3075	Shoe Adjusting Washer Screw	
7	45-88-0380	Washer	(2)	28	34-60-2125	Retaining Ring
8	32-48-1001	Mechanism Gear	(2)	29	44-68-0100	Locking Plug
9	14-30-0220	Gear Case Assembly		30	18-22-1090	Field Assembly
10	02-50-1200	Mechanism Needle Bearings	(6)	31	16-22-1190	Armature Assembly
11	44-60-0260	Mechanism Gear Pin(Incl. W/item 9)	(2)	32	23-44-0020	Brush Retaining Screw
12	28-20-1061	Gear Case Cover		33	22-18-0270	Carbon Brush Assembly
13	42-24-0151	Spindle Bearing Plate		34	22-22-0050	Brush Holder Assembly
14	12-75-1900	Identifying Name Plate		35	02-04-0740	Ball Bearing (Comm. End)
15	44-60-0250	Connecting Rod Pin		36	28-39-0221	Grill
16	44-94-0070	Connecting Rod		37	28-50-4981	Motor Housing
17	42-92-0100	Spindle Bearing Plate Cover		38	44-94-0080	Rip Guide Rod
18	06-83-2620	Spindle Pin Retaining Screw		39	45-58-0120	Rip Guide Locking Stud
19	45-30-0080	Spindle Pin Retaining Slug		40	44-40-0210	Rip Guide Locking Nut
20	44-60-0270	Spindle Drive Pin		41	44-66-0300	Rip Guide End Plate Assembly
21	38-50-4110	Spindle Assembly		42	06-75-2000	8-32x3/8 Soc. Hd. Rip Guide End Plate Sc.

MISCELLANEOUS PARTS NOT SHOWN

PART NO.	DESCRIPTION OF PART	PART NO.	DESCRIPTION OF PART	
06-81-3500	6-32x5/8 Oval Hd. Handle Cover Screw	06-81-5950	6-32x1-7/8 Fil.Hd. Field Sems	(2)
06-81-3650	8-32x3/4 Oval Hd. Handle Cover Screws	(2)	06-81-3450	6-32x5/16 Oval Hd. Grill Mounting Sc. (2)
06-81-6075	8-32x3/8 Fil.Hd. Handle Mounting Sems	(2)	06-81-8625	6-32x1/4 (Bronze) Rd. Hd. Ground Sems
06-81-6550	8-32x1-1/2 Fil.Hd. Handle Mounting Sems		06-83-0100	10-32x1/4 Brush Holder Set Screw
06-81-8650	6-32x1/4 Rd.Hd. Switch Mounting Sems	(2)	12-98-5000	Name Plate
06-81-6300	8-32x7/8 Fil.Hd. Diaphragm Mtg. Sems	(4)	06-81-4950	4-36x3/16 Truss Hd. Name Plate Sc. (2)
06-81-5825	6-32x1/2 Fil.Hd. Gear Case Cover Sems		45-36-0250	Handle Spacer
06-81-5850	6-32x5/8 Fil.Hd. Gear Case Cover Sems	(2)	48-03-0010	Plug Adaptor
06-81-6100	8-32x7/16 Fil.Hd. Bearing Plate Mtg. Sems	(4)	49-96-0060	1/8 Socket Wrench
06-81-6400	8-32x1-1/8 Fil.Hd. Brg. Plate Mtg. Sems	(2)	49-96-0080	3/16 Socket Wrench
06-81-4300	3-48x3/16 Rd.Hd. Name Plage (Identifying)	(3)	48-66-4080	Rubber Flex Chuck Key Holder
06-81-8050	8-32x3/8 Flat Hd. Brg. Plate Cover Sems	(4)	23-86-0070	Fiber Brush Holder Washer
34-60-0550	Retaining Ring		23-48-7325	2" Long Lead Wire Insulating Sleeving
			06-65-0630	3/16x1/2 Type E Drivlok Pin

CORRECTS & SUPERCEDES
SERVICE BULLETIN 6281-1
DATED 6/5/61

Numbers in brackets indicate number required.