



# SERVICE PARTS LIST

**BUL. 54-40-2501**

## CHAIN SAW

REVISED BUL 54-40-2501 DATE Feb.'71

**Catalog No. 6200**

Serial No. 151-2543 Thru 151-10870  
151-12574 Thru 151-12773

WIRING INSTR. 58-01-0320

Both Model and Serial No. must be furnished to obtain correct parts.

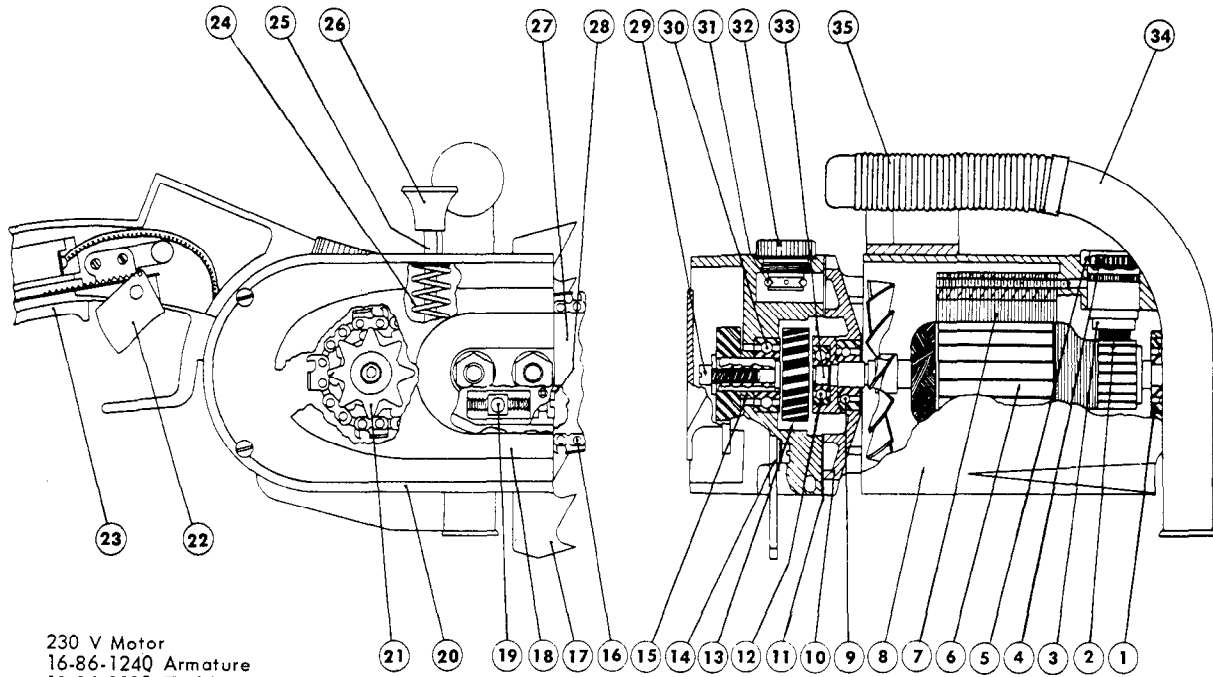

230 V Motor  
16-86-1240 Armature  
18-86-1190 Field

ILLUSTRATED PARTS

FIG.	PART NO.	DESCRIPTION OF PART
1	02-04-1070	Ball Bearing (Comm.)
2	22-18-0055	Brush Assembly (2)
3	22-22-0015	Brush Holder Assembly (2)
4	23-44-0030	Brush Retaining Screw (2)
5	22-24-0110	Brush Holder Bushing (2)
6	16-82-1280	Armature Assembly
7	18-82-1040	Field Assembly
8	28-50-4681	Motor Housing
9	02-04-1260	Ball Bearing
10	28-28-0781	Diaphragm
11	43-44-0060	Diaphragm Gasket
12	02-04-0910	Ball Bearing
13	32-75-1681	Spindle Gear
14	42-70-0070	Wrench Clip
15	45-36-0150	Sprocket Spacer
16	48-58-0050	Chain
17	42-38-0060	Bumper

FIG.	PART NO.	DESCRIPTION OF PART
18	28-20-9011	Sprocket Cover
19	44-40-0230	Chain Adjusting Nut
20	28-14-0801	Gear Case
21	45-44-0050	Drive Sprocket
22	23-66-0300	Switch Assembly
23	28-44-9161	Switch Handle
24	40-50-2200	Pump Shaft Spring
25	36-68-0510	Pump Shaft With Ball Valve Oiler
26	43-98-0090	Knob
27	48-09-5000	Guide Bar
28	45-04-0110	Chain Adjusting Screw
29	06-75-3000	1/4-20x5/8 L.H. Socket Hd. Cap Screw
30	02-04-1640	Ball Bearing
31	34-40-1000	'O' Ring
32	42-92-0060	Oil Filler Cover
33	38-50-3001	Spindle
★34	43-62-0170	Handle Assembly (Includes Fig. 35)
35	43-62-0242	Handle Grip

MISCELLANEOUS PARTS NOT SHOWN

PART NO.	DESCRIPTION OF PART	PART NO.	DESCRIPTION OF PART
06-81-1100	10-24x2-1/2 Lg. Fil. Hd. Gear Case Screws (2)	34-60-0500	Pump Shaft Retaining Ring
06-81-1200	10-24x3-1/2 Lg. Fil. Hd. Gear Case Screws (2)	45-88-5240	17/64x1/2x1/32 Thick Cad. Pl. Pump Shaft Washer
06-55-2500	3/8-16x9/16 Hex Nut	45-88-5261	3/8x7/8x1/16 Thick Cad. Pl. Stud Washer
06-81-7800	1/4-20x3/4 Fil. Hd. Sem Bumper Screw (2)	45-88-0231	Sprocket Washer
06-81-9225	10-24x2-3/4 Rd. Hd. Field Screws (2)	43-44-0070	Oil Filler Cover Gasket
06-83-2650	1/4-20x3/8 Hd'less Brush Holder Set Screws (2)	12-98-3900	Name Plate
06-81-8650	6-32x1/4 Rd. Hd. Sem Comm. Cover Plate Scs. (2)	06-65-0830	1/8 Dia. x 1/2 Groove Pin Type 1
06-81-4100	12-24x1/2 Oval Hd. Handle Fastening Scs. (4)	44-66-0100	Commutator Cover Plate
06-81-1400	12-24x1/2 Fil. Hd. Switch Han. Mtg. Scs (3)	22-64-0090	Cord Set
06-81-6150	8-32x1/2 Fil. Hd. Sem Cord Clamp Screws (2)	28-17-0400	Cord Clamp
06-81-8625	6-32x1/4 Rd. Hd. Sem Ground Scs. (Brass)	49-96-6200	Wrench
06-81-5400	8-32x5/16 Binder Hd. Switch Screws Sem (3)	06-97-1800	Lock Washer (4)
★06-81-8200	4-36x3/16 Rd. Hd. Sem Name Plate Scs. (2)	44-46-0050	Ball Valve with Thread
06-81-3650	8-32x3/4 Oval Hd. Switch Handle Scs.	45-30-0070	Ball Bearing Rubber Slug
06-81-3750	8-32x1 Oval Hd. Switch Handle Screws	28-20-3081	Switch Handle Cover
06-92-1000	3/8-16x1-1/2 Lg. Cad Pl. Guide Bar Studs (2)	23-86-0060	Brush Holder Washer (2)
06-42-2000	Woodruff Key	06-97-3400	Lock Washer (4)
06-97-3600	Lock Washer (4)		