



# SERVICE PARTS LIST

## 1-1/2 H.P. ROUTER

**Catalog No. 5660**

Starting  
Serial No. **452-2367**

**BUL. 54-37-0202**

REVISED BUL.  
54-37-0201

DATE  
Feb. '77

WIRING INSTRUCTIONS  
**58-01-0700**

Specify Catalog and Serial No. when ordering parts

Catalog No. 5660 includes:

5650 Router Motor Assy. (figs. 1 thru 27) and  
48-10-0060 Router Base Assy. (figs. 29 thru 42)

FIG.	PART NO.	DESCRIPTION	NO. REQ.
1	06-81-5825	6-32x1/2 Fil. Hd. Sem	(4)
2	31-17-0050	Cord Clamp	(1)
3	12-98-0100	Nameplate	(1)
★4	22-64-0386	Cord Set	(1)
5	23-44-0130	Brush Cap	(2)
6	22-18-0440	Carbon Brush Assembly	(2)
7	23-66-0860	Switch	(1)
8	06-81-6705	8-32x1-7/8 Fil. Hd. Sem	(4)
9	12-98-6965	Identification Plate	(1)
10	31-12-0060	Upper Bearing Cap Assembly	(1)
11	06-97-5700	Finger Washer	(1)
12	02-04-0895	Ball Bearing	(1)
★13	18-62-1170	115V. Field	(1)
★14	06-81-9195	10-24x2-3/8 Round Hd. Sem	(2)
15	23-16-0675	Insulating Sleeve	(1)
16	23-50-0070	Insulating Spacer	(1)
17	16-62-1170	115V. Armature	(1)
18	06-81-5500	8-32x3/8 Binder Hd. Sem	(3)
19	44-66-5300	Bearing Retainer	(1)
20	02-04-1655	Ball Bearing	(1)
21	28-50-6131	Motor Housing	(1)
22	06-81-8625	6-32x1/4 Slot. Hex. Hd. Ground Screw	(1)
★23	31-58-0010	Adjusting Ring	(1)
★24	45-10-0050	Chuck Shank	(1)
★25	48-66-0945	1/4" Collet	(1)
26	44-40-0375	Collet Nut	(1)
27	06-75-3005	1/4-20x5/8 Socket Hd. Screw	(1)
28	48-10-0060	Router Base (Includes Fig. Nos. 29 thru 42) - See Note	(1)
29	31-44-0270	Handle - See Note	(2)
30	44-90-4200	Support Ring	(2)
31	06-75-3250	1/4-20x1-1/2 Socket Hd. Screw	(2)
32	06-97-4050	Lock Washer	(2)
33	06-75-0230	1/4-20x1-3/4 Hex. Hd. Screw	(1)
34	28-06-0811	Base Assembly (Incl. Fig. Nos. 35 and 36)	(1)
35	06-65-0575	3/32x5/16 Long Pin	(1)
36	12-98-7075	Router Base Nameplate	(1)
37	31-06-0070	Sub Base	(1)
38	06-81-5625	8-32x1/4 Pan Hd. Sem	(2)
39	06-97-5600	Lock Washer	(1)
40	45-36-0680	Locking Knob Spacer	(1)
41	43-98-0070	Locking Knob	(1)
★42	06-81-2580	8-32x1/2 Flat Hd. Screw	(4)

**NOT SHOWN**

★ 49-96-4070	7/8 Open End Wrench	(1)
★ 49-96-4080	1-1/8 Open End Wrench	(1)
★ 12-98-7081	Caution Plate	(1)

FOR CAT. NO. 5660-2

(240V) TOOL USE:

18-66-1170	FIELD
16-66-1170	ARMATURE
22-64-4100	CORD SET

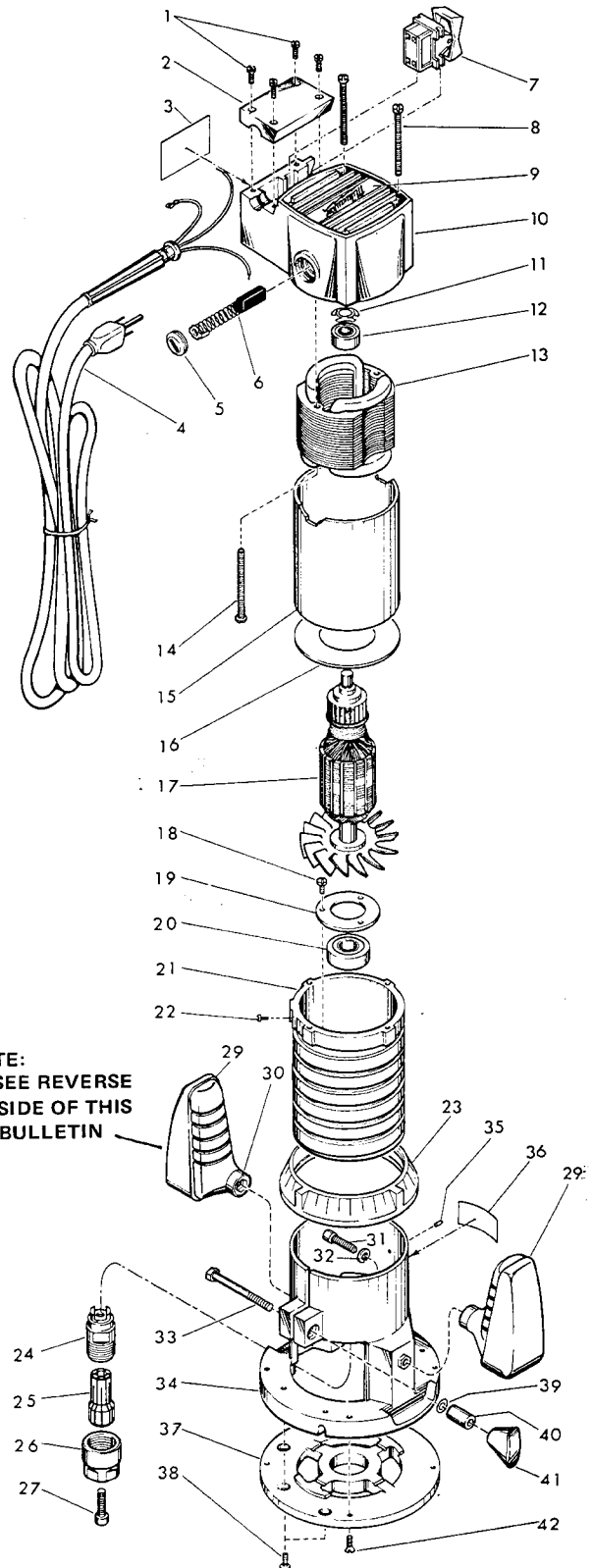

Handle (Fig. No. 29) has been revised. Some tools covered by this parts list were made using the new handles.

If the handle is attached to the router base with a screw inserted from the outside of the tool, refer to the following sketch for assembly and correct selection of parts.

