



# SERVICE PARTS LIST

**BUL. 54-32-1103**

**POLISHER**

REVISED BUL.  
54-32-1103

DATE  
June '74

**Catalog No. 5530**

Starting  
Serial No. **140-4028**

WIRING INSTRUCTIONS  
**58-01-0300**

Specify Catalog and Serial No. when ordering parts

2800 R.P.M.

**FOR 230V TOOL USE:**  
18-66-1035 FIELD  
16-66-1035 ARMATURE  
22-64-2090 CORD SET

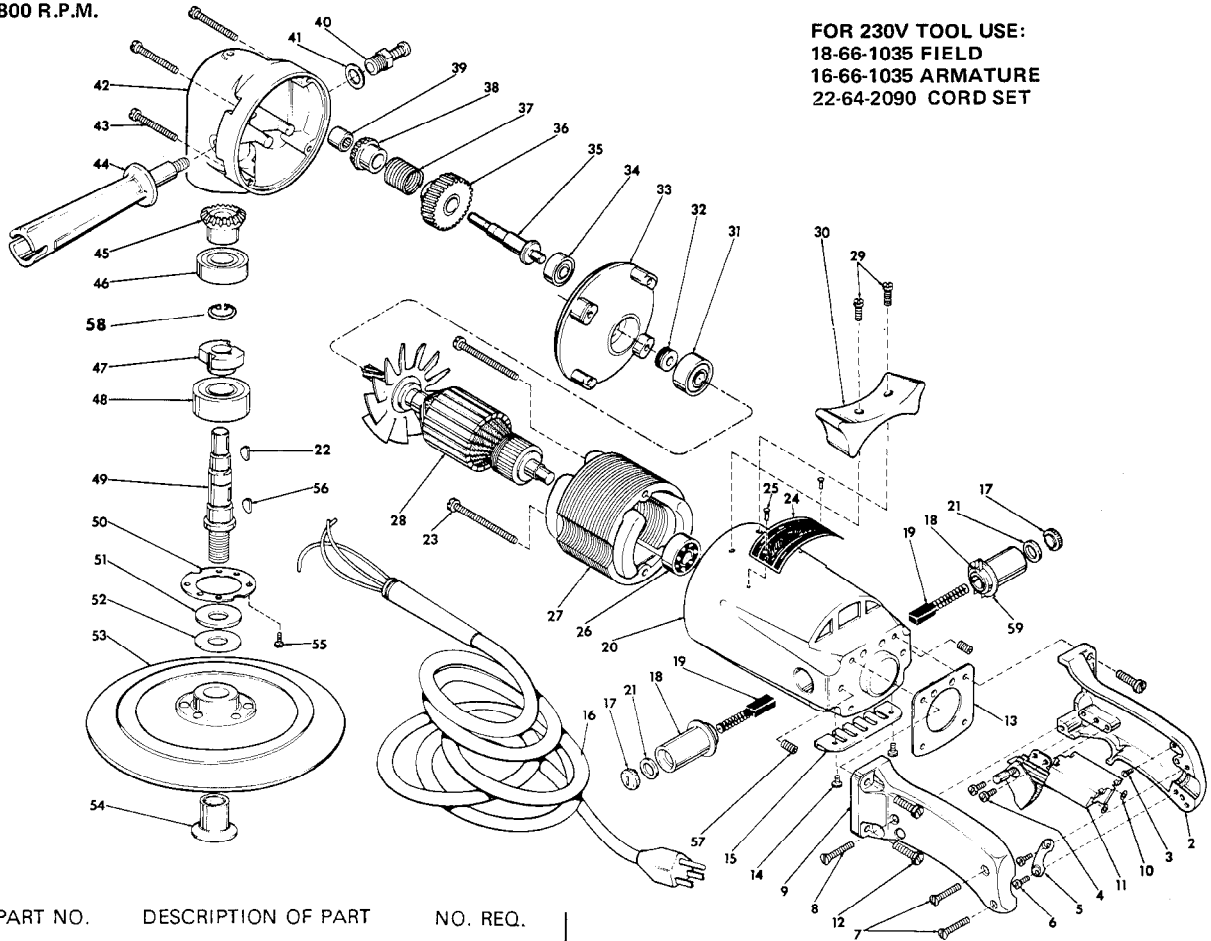

FIG.	PART NO.	DESCRIPTION OF PART	NO. REQ.
★ 1	28-44-1042	Switch Handle Assembly (includes Fig. Nos. 2, 7, 8 and 9)	(1)
2	-	Handle (Switch Mount Side)	(1)
3	06-81-8625	6-32x1/4 Ground Screw	(1)
4	06-81-5400	8-32x5/16 Binder Sem	(2)
5	28-17-0200	Clamp Strap	(1)
6	06-81-6150	8-32x1/2 Fil. Hd. Sem	(2)
7	06-81-3700	8-32x7/8 Oval Hd. Screw	(2)
8	06-81-3750	8-32x1 Oval Hd. Screw	(1)
9	-	Handle (Switch Cover Side)	(1)
10	06-97-1800	Lockwasher	(4)
11	23-66-0160	Switch	(1)
12	06-81-7550	12-24x3/4 Fil. Hd. Sem	(4)
13	43-86-0050	Handle Insulator	(1)
14	06-81-8650	6-32x1/4 Rd. Hd. Sem	(2)
15	44-66-0230	Cover Plate	(1)
16	22-64-0090	Cord Set	(1)
17	23-44-0100	Brush Retaining Screw	(2)
18	22-22-0231	Brush Holder Assy.	(2)
★ 19	22-18-0330	Carbon Brush Assy.	(2)
20	28-50-4885	Motor Housing	(1)
21	43-44-0180	Brush Cap Gasket	(2)
22	06-42-1200	Woodruff Key	(1)
23	06-81-8950	8-32x2-1/4 Rd. Hd. Sem	(2)
★ 24	12-99-0032	Nameplate	(1)
★ 25	06-85-0200	6x1/4 Rd. Hd. Type Z Screw	(2)
26	02-04-0970	Ball Bearing	(1)
27	18-62-1035	115 Volt Field	(1)
28	16-62-1035	115 Volt Armature	(1)
29	06-81-6950	10-24x1/2 Fil. Hd. Sem	(2)
30	28-79-0321	Tool Rest	(1)
31	02-04-1260	Ball Bearing	(1)

FIG.	PART NO.	DESCRIPTION OF PART	NO. REQ.
32	45-28-0060	Grease Slinger	(1)
33	28-28-0981	Diaphragm	(1)
34	02-04-0910	Ball Bearing	(1)
35	36-66-3251	Intermediate Shaft	(1)
36	32-40-1311	Intermediate Gear	(1)
37	40-50-3100	Drive Spring	(1)
38	32-05-1101	Bevel Gear (Sold with fig. 45 as a set)	(1)
39	02-50-1630	Needle Bearing	(1)
40	44-20-0060	Spindle Lock Assembly	(1)
41	45-88-5320	Flat Washer	(1)
42	28-14-1082	Gear Case	(1)
43	06-81-7300	10-24x1-3/4 Fil. Hd. Sem	(4)
★ 44	43-62-0570	Side Handle	(1)
45	32-05-1081	Bevel Gear (Refer to fig. 38)	(1)
46	02-04-1710	Ball Bearing	(1)
★ 47	42-74-0065	Spindle Lock Cog	(1)
48	02-04-2060	Ball Bearing	(1)
49	38-50-3751	Spindle	(1)
50	45-88-0220	Retaining Washer	(1)
51	45-88-0141	Thrust Washer	(1)
52	45-88-0160	Rubber Washer	(1)
53	49-36-2500	7" Rubber Backing Pad	(1)
★ 54	49-40-0160	Disc Nut	(1)
55	06-81-6050	8-32x5/16 Fil. Hd. Sem	(6)
56	06-42-1600	Woodruff Key	(1)
57	06-83-2620	1/4-20x1/4 Hdls. Set Screw	(2)
★ 58	34-60-1290	Retaining Ring	(1)
59	23-86-0075	Washer	(2)
★ 60	12-98-7081	Caution Plate (Not Shown)	(1)

**MILWAUKEE ELECTRIC TOOL CORP.**

13135 West Lisbon Road • Brookfield, Wisconsin 53005