



SERVICE PARTS LIST

BUL.54-32-1007

POLISHER

REVISED BUL 54-32-1007 DATE Jan,'70

Catalog No. 5450

Starting Serial No. **100-9601**

WIRING INSTR. **58-01-0300**

Both Model and Serial No. must be furnished to obtain correct parts.

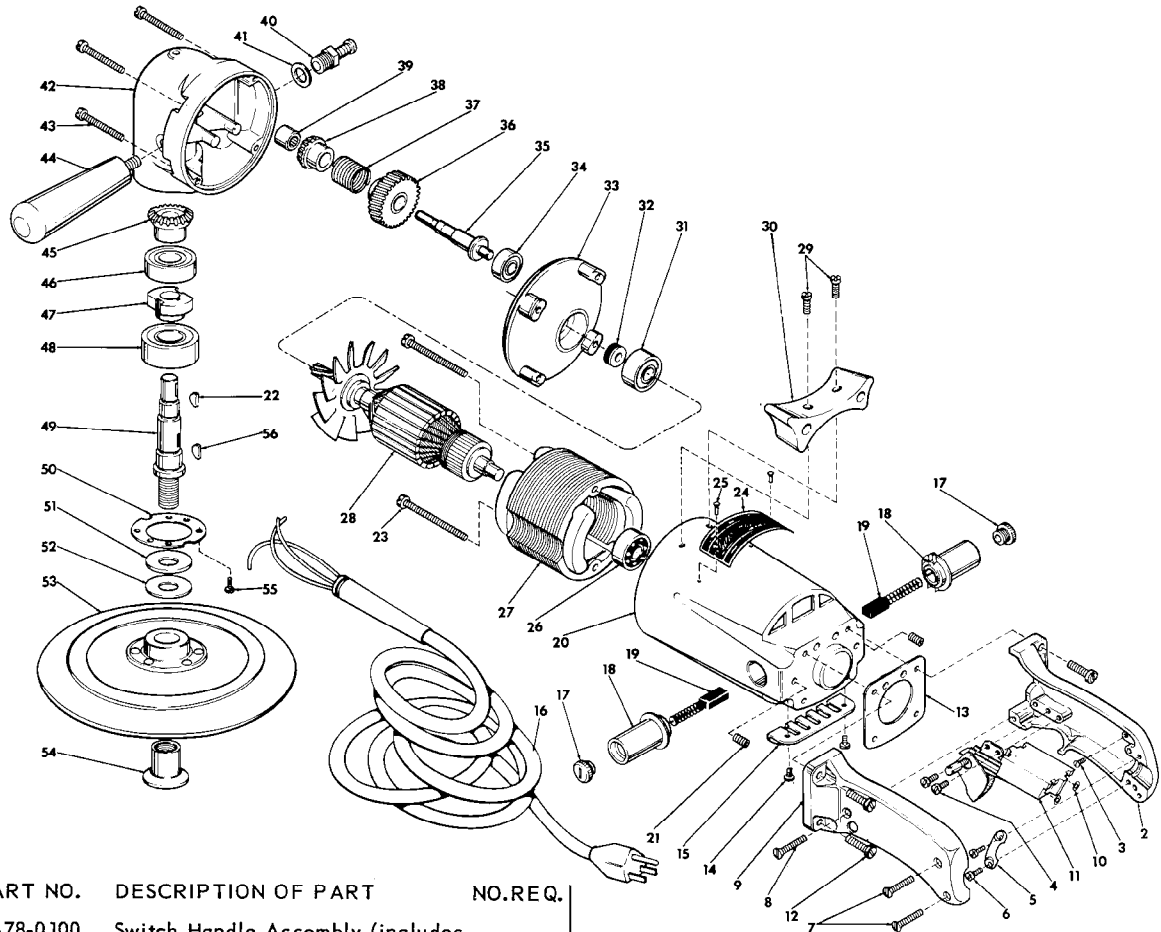

FIG.	PART NO.	DESCRIPTION OF PART	NO.REQ.
1	14-78-0100	Switch Handle Assembly (includes Fig. Nos. 2 thru 9)	
2	28-44-1041	Handle (Switch Mount Side)	
3	06-81-8625	6-32x1/4 Rd.Hd. Bronze	
4	06-81-5400	8-32x5/16 Binder Sem	(2)
5	28-17-0200	Clamp Strap	
6	06-81-6150	8-32x1/2 Fil.Hd. Sem	(2)
7	06-81-3700	8-32x7/8 Oval Hd. Screw	(2)
8	06-81-3750	8-32x1 Oval Hd. Screw	
9	28-44-9081	Handle (Switch Cover Side)	
10	06-97-1800	Lockwasher	(4)
11	23-66-0160	Switch	
12	06-81-7550	12-24x3/4 Fil.Hd. Sem	(4)
13	43-86-0050	Handle Insulator	
14	06-81-8650	6-32x1/4 Rd.Hd. Sem	(2)
15	44-66-0230	Coverplate	
16	22-64-0090	Cord Set	
17	23-44-0065	Brush Retaining Screw	(2)
18	22-22-0120	Brush Holder Assy.	(2)
19	22-18-0170	Carbon Brush Assy.	(2)
20	28-50-4881	Motor Housing	
21	06-83-2650	1/4-20x3/8 Knrl. Set Screw	(2)
22	06-42-1200	Woodruff Key	
23	06-81-8950	8-32x2-1/4 Rd.Hd. Sem	(2)
24	12-98-2500	Nameplate	
★25	06-77-0625	6-1/4 Rd. Drive-In Screw	(2)
26	02-04-0970	Ball Bearing	
27	18-62-1030	115 Volt Field	
28	16-62-1030	115 Volt Armature	
29	06-81-6950	10-24x1/2 Fil.Hd. Sem	(2)

FIG.	PART NO.	DESCRIPTION OF PART	NO.REQ.
30	28-79-0321	Tool Rest	
31	02-04-1070	Ball Bearing	
32	45-28-0070	Grease Slinger	
33	28-28-1101	Diaphragm	
34	02-04-0910	Ball Bearing	
35	36-66-3251	Intermediate Shaft	
36	32-40-1401	Intermediate Gear	
37	44-50-3100	Drive Spring	
38	32-05-1101	Bevel Gear (Sold with fig.45 as a set)	
39	02-50-1630	Needle Bearing	
40	44-20-0060	Spindle Lock Assembly	
41	45-88-5320	Flat Washer	
42	28-14-1082	Gear Case	
43	06-81-7300	10-24x1-3/4 Fil.Hd. Sem	(4)
44	43-62-0141	Side Handle	
45	32-05-1081	Bevel Gear (Refer to fig.38)	
46	02-04-1710	Ball Bearing	
47	42-74-0061	Spindle Lock Cog	
48	02-04-2060	Ball Bearing	
49	38-50-3751	Spindle	
50	45-88-0220	Retaining Washer	
51	45-88-0141	Thrust Washer	
52	45-88-0160	Rubber Washer	
53	49-36-2500	7 in. Rubber Backing Pad	
54	44-40-0160	Disc Nut	
55	06-81-6050	8-32x5/16 Fil. Hd. Sem	(6)
56	06-42-1600	Woodruff Key	