



SERVICE PARTS LIST

BUL. 54-22-9024

6" GRINDER

REVISED BUL 6155-5 DATE Feb. '68

Catalog No. 5240-8

Starting Serial No. 155-2845

WIRING INSTR.

Both Model and Serial No. must be furnished to obtain correct parts.

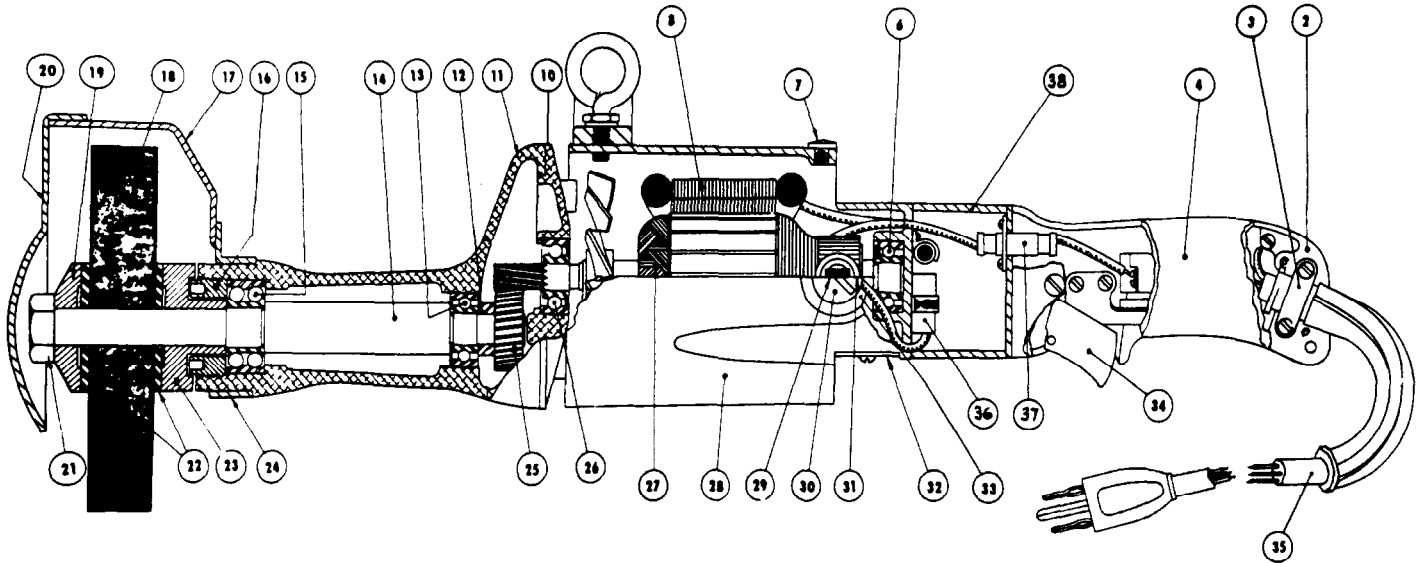

FIG. PART NO.	DESCRIPTION OF PART	FIG. PART NO.	DESCRIPTION OF PART
2	28-44-1041 Handle (Switch Mounting Side)	21	06-55-3250 5/8-11 Spindle Nut
3	28-17-0200 Cord Clamp Strap	22	45-88-0260 Rubber Flange Washers
4	28-44-9081 Handle (Switch Cover Side)	23	43-34-0070 Inner Wheel Flange
6	02-04-1070 Ball Brg. (Comm. End)	24	Sold only as an Assembly
7	06-77-1400 Drive Screw Tool Rest Button	25	32-75-2281 Spindle Gear
8	18-82-1170 Field Assembly	26	02-04-1140 Ball Brg. (Pinion End)
10	28-28-1021 Diaphragm	27	16-82-1460 Armature Assembly
11	28-50-7601 Spindle Housing	28	14-38-0260 Eyebolt, Tool Rest, Motor Housing Assy.
12	45-36-0220 Spindle Gear Spacer	29	22-18-0260 Carbon Brush Assemblies (per set 2)
13	02-04-1520 Ball Brg. (Inner)	30	23-44-0065 Brush Ret. Cap Assy. (per set 2)
14	38-50-3901 Spindle	31	22-22-0130 Brush Holder Assembly (2)
15	02-20-1720 Ball Brg. (Outer)	32	44-66-0100 Commutator Cover Plate
16	44-40-0180 Bearing Lock Nut	33	22-24-0100 Brush Holder Bushing Steel (2)
17	43-54-0120 6" Guard Assembly	34	23-66-0250 Switch Assembly
18	49-92-3240 6x1x5/8 hole Grinding Wheel (24 Grit)	35	22-64-0160 Cord Set
19	43-34-0060 Outer Wheel Flange	36	22-33-3550 .1 MFD Condenser (2)
20	Sold only as an Assembly	37	22-33-6550 .02 MFD Condenser (2)
		38	28-50-8122 Radio Suppression Box

MISCELLANEOUS PARTS NOT SHOWN

PART NO.	DESCRIPTION OF PART	PART NO.	DESCRIPTION OF PART
12-30-3700	Name Plate	06-97-2400	Lockwasher (4)
23-86-0130	Insulating Washers (2)	06-81-8650	6-32x1/4 Rd. Hd. Condenser Mounting Sem (6)
06-81-6100	No. 8-32x7/16 Fil. Hd. Cord Clamp Strap Sems (2)	06-81-8625	No. 6-32x1/4 Rd. Hd. Ground Wire Scr. (Brass)
06-81-7150	No. 10-24x1-3/8 Fil. Hd. Spindle Housing Scr. (4)	06-81-5400	No. 8-32x5/16 Binder H.D. Switch Mounting Scr. (2)
06-81-3750	No. 8-32x1 Oval Hd. Handle Cover Screw	06-81-8200	No. 4-36x3/16 Rd. Hd. Name Plate Sems (2)
06-81-3700	No. 8-32x7/8 Oval Hd. Handle Cover Screw (2)	06-81-8650	No. 6-32x1/4 Rd. Hd. Comm. Cover Plate Scr. (2)
06-81-8950	No. 8-32x2-1/4 Rd. Hd. Field Screws (2)	06-81-6950	No. 10-24x1/2 Fil. Hd. Tool Rest Sem (2)
06-83-2650	1/4-20x3/8 Hd'less Brush Holder Set Scr. (2)	06-97-3200	No. 8 Kantlink Lockwasher
06-81-1625	No. 12-24x2-1/4 Fil. Hd. Switch Handle Scr. (4)	06-97-3400	No. 10 Kantlink Lockwasher
06-77-0450	4x1/4 Rd. Hd. Drive-in Screw (2)	12-98-5200	Identification Name Plate
		12-98-5100	Warning Plate