



SERVICE PARTS LIST

REVERSING DRAIN CLEANER

Catalog No. 0566-1

Starting Serial No. **496-1001**

Specify Catalog and Serial No. when ordering parts

BUL. 54-05-0125

REVISED BUL. DATE
April, '78

WIRING INSTRUCTIONS
58-01-0645

0-500 R.P.M.
1.85 AMPS

FOR CAT. NO. 0566-3 (240V) TOOL USE:

18-26-1061 FIELD
22-18-0375 CARBON BRUSH
23-66-0798 SWITCH
16-26-1221 ARMATURE
22-64-4200 CORD SET

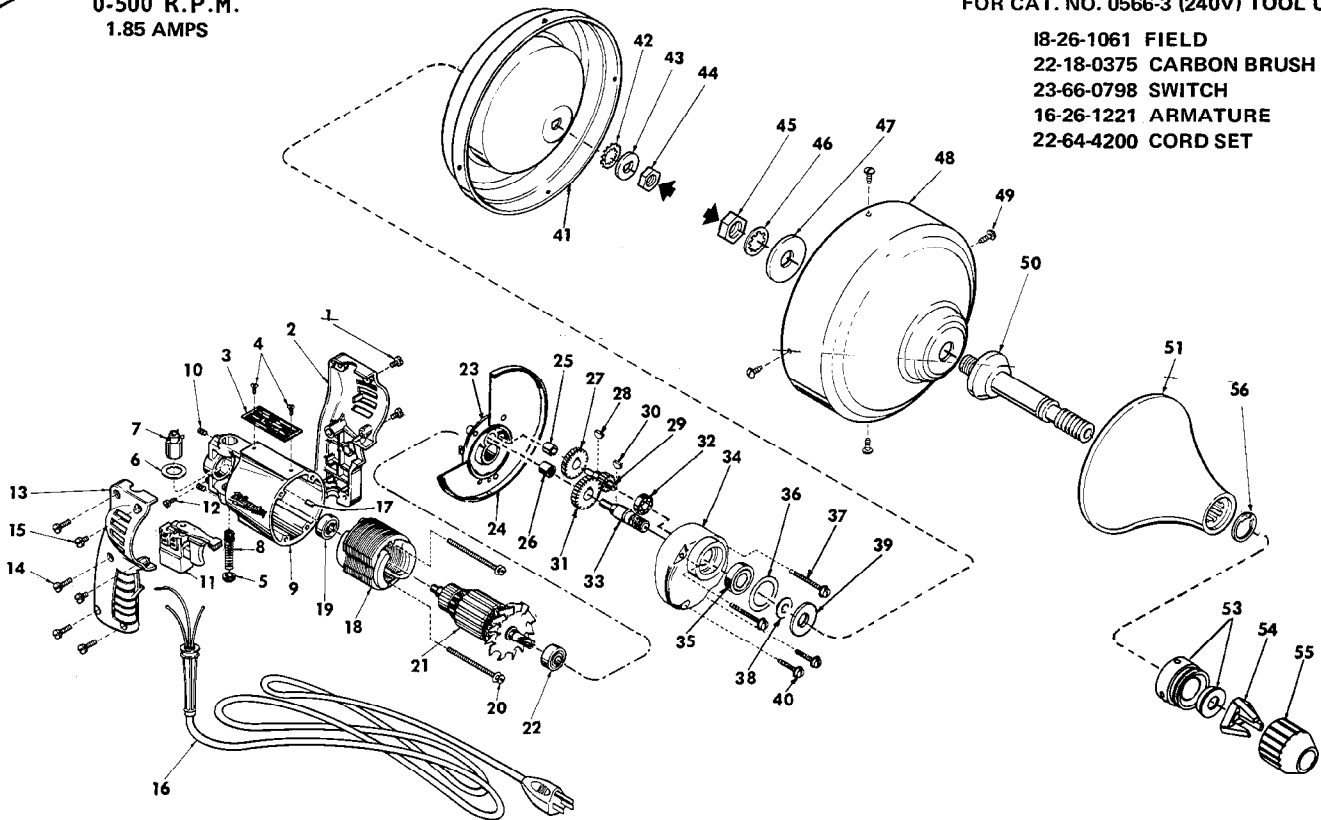

| FIG. | PART NO. | DESCRIPTION OF PART | NO. REQ. |
|------|------------|-----------------------------------|----------|
| 1 | 06-81-0452 | 8-32x3/8 Pan Hd. Screw | (2) |
| 2 | 31-44-0620 | L.H. Handle Half | (1) |
| 3 | 12-99-0022 | Nameplate Blank | (1) |
| 4 | 06-85-0200 | Nameplate Screws | (2) |
| 5 | 23-44-0020 | Brush Retaining Cap | (2) |
| 6 | 23-86-0105 | Insulating Washer | (2) |
| 7 | 22-22-1251 | Brush Holder Assy. | (2) |
| 8 | 22-18-0155 | Carbon Brush Assy. | (2) |
| 9 | 28-50-6091 | Motor Housing (Incl. Fig. No. 17) | (1) |
| 10 | 06-83-2430 | 10-32x1/4 Hdls. Skt. Screw | (2) |
| 11 | 23-66-0797 | Rev. Speed Control Switch | (1) |
| 12 | 06-81-8625 | 6-32x1/4 Ground Screw | (1) |
| 13 | 31-44-0610 | R.H. Handle Half | (1) |
| 14 | 06-81-0402 | 8-32x3/4 Pan Hd. Screw | (4) |
| 15 | 06-81-0452 | 8-32x3/8 Pan Hd. Screw | (2) |
| 16 | 22-64-0665 | Cord Set | (1) |
| 17 | 45-30-0120 | Ball Bearing Ret. Slug | (1) |
| 18 | 18-22-1060 | Field | (1) |
| 19 | 02-04-0740 | Ball Bearing | (1) |
| 20 | 06-81-5950 | 6-32x1-7/8 Fil. Hd. Sems | (2) |
| 21 | 16-22-1221 | Armature Assy. | (1) |
| 22 | 02-04-0740 | Ball Bearing | (1) |
| 23 | 28-28-0221 | Diaphragm | (1) |
| 24 | 45-12-0210 | Shield | (1) |
| 25 | 02-50-1210 | Needle Bearing | (1) |
| 26 | 02-50-1640 | Needle Bearing | (1) |
| 27 | 32-40-1121 | Intermediate Gear | (1) |
| 28 | 06-42-0400 | Woodruff Key | (1) |
| 29 | 36-66-0851 | Intermediate Pinion Shaft | (1) |

| FIG. | PART NO. | DESCRIPTION OF PART | NO. REQ. |
|------|------------|-------------------------------------|----------|
| 30 | 06-42-0800 | Woodruff Key | (1) |
| 31 | 32-75-1101 | Spindle Gear | (1) |
| 32 | 02-04-0640 | Ball Bearing | (1) |
| 33 | 38-50-4001 | Spindle | (1) |
| 34 | 28-14-0363 | Gear Case | (1) |
| 35 | 02-04-1020 | Ball Bearing | (1) |
| 36 | 34-80-1400 | Retaining Ring | (1) |
| 37 | 06-81-6575 | 8-32x1-5/8 Fil. Hd. Sems | (2) |
| 38 | 45-88-0080 | Spacer | (1) |
| 39 | 45-36-0621 | Spacer | (1) |
| 40 | 06-81-6350 | 8-32x1 Fil. Hd. Sems | (2) |
| 41 | 43-11-0020 | Upper Drum Section | (1) |
| 42 | 06-97-4130 | Lock Washer | (1) |
| 43 | 45-88-7235 | "D" Hole Washer | (1) |
| 44 | 06-55-2450 | 3/8-24 Hex Nut | (1) |
| 45 | 06-55-3760 | Hex Nut | (1) |
| 46 | 06-97-3010 | Internal Lockwasher | (1) |
| 47 | 45-88-7175 | Wrought Washer | (1) |
| 48 | 43-11-0030 | Lower Drum Section | (1) |
| 49 | 06-85-0380 | 6-20x3/8 Phillips Pan Hd. Tek Screw | (4) |
| 50 | 38-50-5055 | Spindle Assembly | (1) |
| 51 | 43-54-0320 | Hand Guard Assembly | (1) |
| 52 | 48-66-0270 | Chuck (Fig. Nos. 53 thru 55) | (1) |
| 53 | 42-30-0270 | Chuck Body and Thrust Plug | (1) |
| 54 | 42-77-0010 | Chuck Collet | (1) |
| 55 | 45-22-0310 | Chuck Sleeve | (1) |
| 56 | 34-60-2310 | Retaining Ring | (1) |
| 57 | 12-98-7081 | Caution Plate (Not Shown) | (1) |